

# Inductive Proximity Sensors

DC Standard

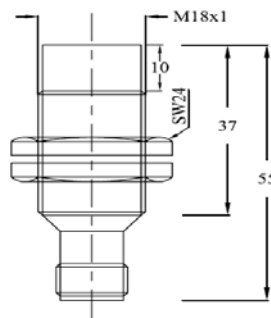

## Dimensions



## Dimensions

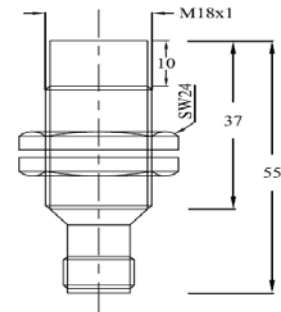

## Technical Data

Model	IPS-C29-213L IPS-C29-213N	IPS-C29-223L IPS-C29-223N
<b>General specifications</b>		
Switching Output	PNP, N/O PNP, N/C	NPN, N/O NPN, N/C
Rated Operating Distance	$S_n$ 8mm $\pm$ 10%	8mm $\pm$ 10%
Installation	Non-Flush	Non-Flush
<b>Nominal Ratings</b>		
Supply Voltage	$U_e$ 10-30 Vdc	10-30 Vdc
Frequency of Operating cycle	$f$ 250 Hz	250 Hz
Hysteresis/Differential travel	$H$ $\pm$ 10%	$\pm$ 10%
Rated operating current	$I_e$ 200 mA	200 mA
No-load supply current	$I_o$ < 15 mA	< 15 mA
Voltage drop	$U_d$ < 2.2Vdc	< 2.2Vdc
OFF state current	$I_r$ < 0.1mA	< 0.1mA
Rated insulation voltage	$U_i$ 75 Vdc	75 Vdc
Utilization category	DC-13	DC-13
Repeatability/ Repeat accuracy	$R$ 0.3 mm	0.3 mm
Protection Circuit	Short circuit & Polarity reversal	Short circuit & Polarity reversal
Function Indication	LED	LED
<b>Ambient Conditions</b>		
Operating temperature	-25° C to +70° C	-25° C to +70° C
<b>Mechanical Specifications</b>		
Connection Type	4 pin Connection M12	4 pin Connection M12
Housing material	CuZn-Nickel Plated	CuZn-Nickel Plated
Sensing face	Plastic ABS-Grey Color	Plastic ABS-Green Color
Back cap	PC-Translucent	PC-Translucent
Degree of protection	IP67	IP67
<b>Compliance with Standards and Directives</b>		
Standards Conformity	EN 60947- 5-2	EN 60947- 5-2
Approval	CE	CE